

HUNTERS[®]

HERE TO GET *you* THERE



Clare Court

Lower Camden, Chislehurst, BR7 5JB

Offers In Excess Of £375,000



Flat 11 Clare Court

Lower Camden, Chislehurst, BR7 5JB

Offers In Excess Of £375,000



GROUND FLOOR
GROUND FLOOR

GARAGE EN-BLOC

ENTRANCE HALL
ENTRANCE HALL

FIRST FLOOR LANDING
FIRST FLOOR LANDING

LOUNGE
12'10" x 17'3" (3.91 x 5.26)
LOUNGE

DINING ROOM
9'7" x 10'2" (2.92 x 3.1)
DINING ROOM

KITCHEN
7'8" x 9'10" (2.34 x 3)
KITCHEN

SECOND FLOOR
SECOND FLOOR

BEDROOM ONE
12'2" x 17'4" (3.71 x 5.28)
BEDROOM ONE

BEDROOM TWO
10'2" x 10'7" (3.1 x 3.23)
BEDROOM TWO

BATHROOM
BATHROOM

OUTSIDE
OUTSIDE

GARAGE EN-BLOC

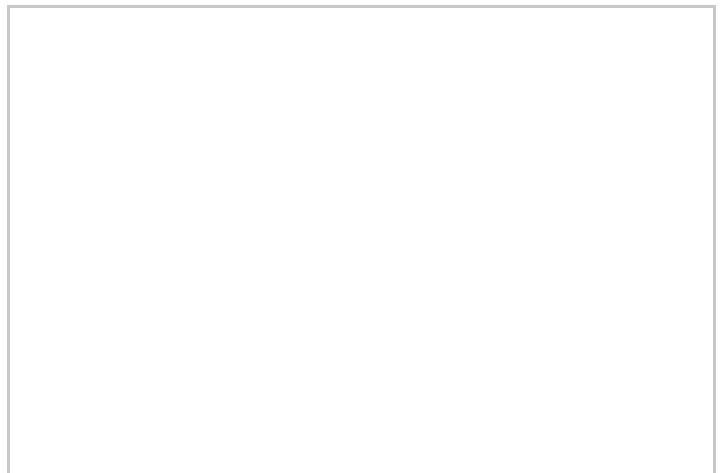

Road Map



Hybrid Map



Terrain Map



Floor Plan

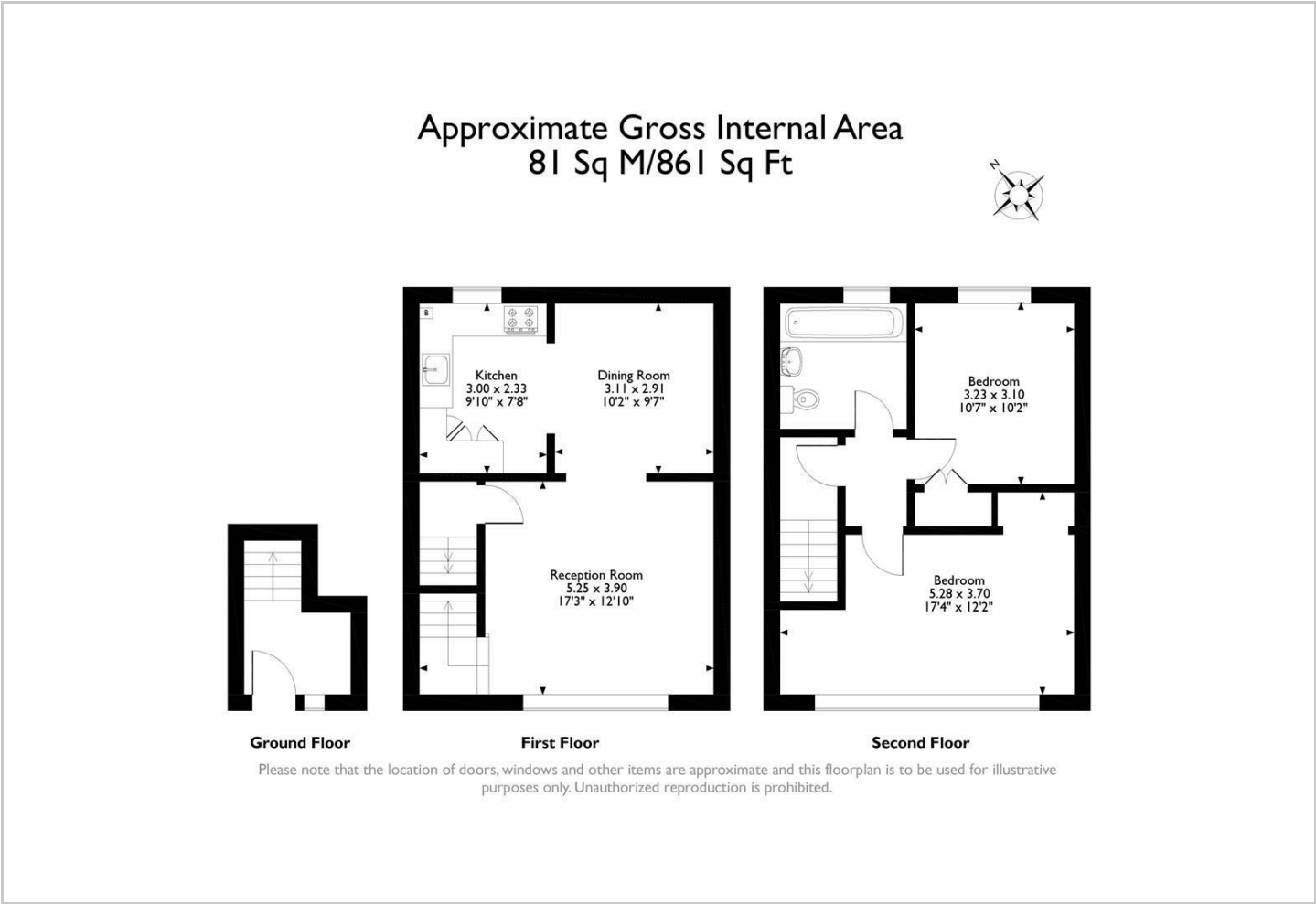

Viewing

Please contact our Hunters Bromley & Chislehurst Office on 020 8467 1818 if you wish to arrange a viewing appointment for this property or require further information.

Energy Efficiency Graph

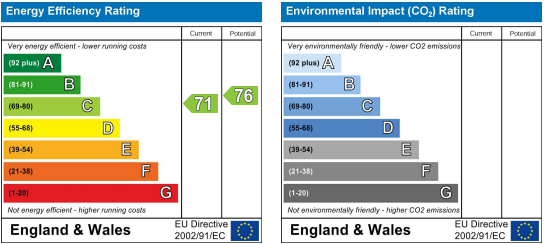

These particulars are intended to give a fair and reliable description of the property but no responsibility for any inaccuracy or error can be accepted and do not constitute an offer or contract. We have not tested any services or appliances (including central heating if fitted) referred to in these particulars and the purchasers are advised to satisfy themselves as to the working order and condition. If a property is unoccupied at any time there may be reconnection charges for any switched off/disconnected or drained services or appliances - All measurements are approximate. **THINKING OF SELLING?** If you are thinking of selling your home or just curious to discover the value of your property, Hunters would be pleased to provide free, no obligation sales and marketing advice. Even if your home is outside the area covered by our local offices we can arrange a Market Appraisal through our national network of Hunters estate agents.